

- NOTES:**
- 1- ONLY THE ITEMS WITH QUANTITIES SPECIFIED ON PARTS LIST ARE USED ON THIS APPLICATOR.
  - USED IN PLACE OF ITEM 38 WHEN INSULATION CRIMP IS NOT USED.
  - GUARD MUST BE IN PLACE WHEN OPERATING APPLICATOR IN AMP-O-LECTRIC PRESS.
  - 4- PARTS WITH QTY. OF REF. SPECIFIED (EXCEPT ITEM 79) ARE USED ON ITEM 46.
- KEY:**
- RECOMMENDED SPARE PARTS CUSTOMER RESPONSIBLE FOR REPLACEMENT.
  - LUBRICATE DAILY USING NO. 20 MACHINE OIL.

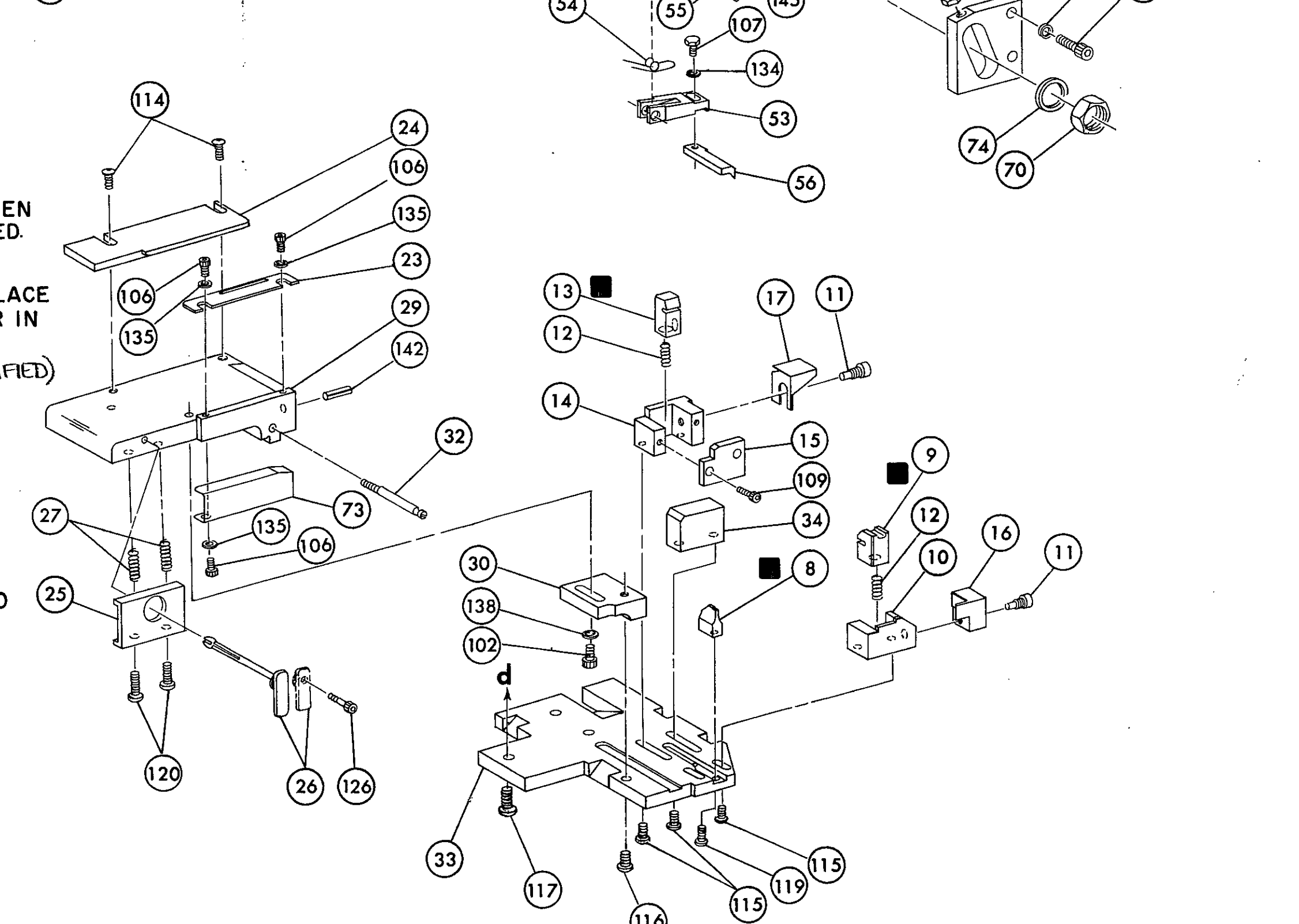

REF	PART NO	DESCRIPTION	ITEM NO
21045-3	RING, RETAINING 'C' (.187 DIA) FEED FINGER PIN	145	REF
REF	5-21028-1	PIN, SLOT SPR (.125 DIA X .50) ADJ ROD	143
1	4-21028-0	PIN, SLOT SPR (.093 DIA X .75) STR G PLATE	142
REF	1-21030-1	PIN, DOWEL (.187 DIA X .50) LEVER	141
REF	1-21030-6	PIN, DOWEL (.187 DIA X 1.25) HOUSING	140
—	21024-5	WASHER, LOCK (NO 10) LUB ASSY	139
1	21024-5	WASHER, LOCK (NO 10) STRIP GUIDE ADJ BLOCK	138
REF	21024-5	WASHER, LOCK (NO 10) ADJ PLATE	137
REF	21024-5	WASHER, LOCK (NO 10) FEED GUIDE ROD	136
3	21057-2	WASHER, LOCK (NO 4) FRONT STRIP GUIDE	135
1	21024-4	WASHER, LOCK (NO 8) FEED FINGER	134
2	21024-4	WASHER, LOCK (NO 8) DEPRESSOR	133
1	21024-4	WASHER, LOCK (NO 8) STRIPPER	132
REF	21899-4	WASHER, FLAT (5/16 DIA) SCREW ADJ	131
—	21899-2	WASHER, FLAT (NO 10) LUB ASSY	130
1	21068-5	NUT, HEX MACH (6-32) HOLDDOWN	129
REF	21068-5	NUT, HEX MACH (6-32) FEED ADJ	128
—	22353-8	SCR, SHLD. (.187 DIA X .250 LG) DRAG LEVER	126
1	21009-2	SCR, SKT SET (1/4-20 X .25) (LOC-WEL) RAM	125
REF	3-21064-2	SCR, RD HD MACH (6-32 X 1.50) FEED ADJ	124
2	2-21002-9	SCR, BUT HD SKT CAP (10-32 X .75) DRAG	123
1	22733-8	SCR, BUT HD SKT CAP (8-32 X .38) (LOC-WEL) ANVIL	122
REF	2-21002-9	SCR, BUT HD SKT CAP (10-32 X .75) CAP	121
REF	1-24073-9	SCR, BUT HD SKT CAP (1/4-20 X .75) HOUSING	120
REF	2-21002-7	SCR, BUT HD SKT CAP (10-32 X .50) SG ADJ BLOCK	119
2	2-21002-2	SCR, BUT HD SKT CAP (8-32 X .50) R STRIP GUIDE	118
1	2-21003-0	SCR, FLAT HD SKT CAP (6-32 X .50) CAM	117
—	3-21000-4	SCR, SKT HD CAP (10-32 X .38) LUBRICATOR ASSY	116
2	23030-1	SCR, SKT HD CAP (6-32 X .25) (LOC-WEL) CP DISC	115
2	2-21000-7	SCR, SKT HD CAP (8-32 X .50) DEPRESSOR	114
1	2-22603-0	SCR, HEX HD MACH (8-32 X .31) FEED FINGER	113
3	1-21000-3	SCR, SKT HD CAP (4-40 X .25) F STRIP GUIDE	112
1	2-21000-7	SCR, SKT HD CAP (8-32 X .50) STRIPPER	111
REF	3-21000-7	SCR, SKT HD CAP (10-32 X .75) FEED ROD GUIDE	110
REF	3-21000-6	SCR, SKT HD CAP (10-32 X .62) FEED ADJ BLOCK	109
1	3-21000-4	SCR, SKT HD CAP (10-32 X .38) SG ADJ BLOCK	108
REF	3-21000-4	SCR, SKT HD CAP (10-32 X .38) PIVOT BLOCK	107
REF	455749-1	GUARD, WINDOW	106
—	1-465184-0	LUBRICATOR ASSY	105
REF	458109-1	WASHER, SPECIAL	104
1	454877-3	PLATE, STRIP GUIDE COVER	103
2	690603-1	SPRING, ASSIST	102
REF	690517-1	SPACER	101
—	22594-8	NUT, HEX	100
—	240628-1	PLATE, ADJUSTMENT	99
—	240626-1	SHAFT, PIVOT	98
—	240633-1	BUSHING	97
—	455680-1	LEVER, INTERMEDIATE	96
—	240629-1	BLOCK, PIVOT	95
—	240632-2	SCREW, ADJUSTMENT FEED ROD	94
—	240659-3	PIN, CAM ROLLER	93
—	240658-1	ROLLER, CAM	92
—	454398-2	ROD, FEED	91
REF	454178-1	GUIDE, FEED ROD	90

CRIMPING DATA					APPLICATOR WILL APPLY	
PAD LTR	CRIMP HEIGHT	WIRE SIZE	WIRE STRIP LENGTH	FORGN.	42642	
A	NOT	USED	20	150526		
B	.035	20				
C	NOT	USED		770261		
D	.032	22				

REMARKS AMPOMATOR

WIRE RANGE 22-20 INSULATION RANGE .100MAX. PRESS # —

CRIMP SIZE TYPE FEED APPL INST  
 WIRE .070 F .350 A1 8040  
 INSUL .100 F

REMARKS: **—INACTIVE—**

APPL USED ON MACHINE PART NO

CUSTOMER NAME

ADDRESS

CITY

REV	DATE	DESCRIPTION	BY	CHK	APP
1	015D-0729-26				
2	015D-0515-95				
3	ECN A-393792				
4	ECN A157588				
5	REV PER ECU R4812				
6	REV PER ECU E-4270				
7	REV PER P 3209				



LOC A D No 466285-1

NAME: MINIATURE QUICK CHANGE APPLICATOR  
SIDE FEED (AMP-IN)

THIS DRAWING IS A CONTROLLED DOCUMENT.

THIS DRAWING IS UNCLASSIFIED, DATE 03-18-03 BY 60337/UC/BAW/STP/MLK